

**APPLICATION AND
MOUNTING INSTRUCTIONS**

DuraLED® REVERSING LAMP
Multivolt 9 - 33 volts

Lens Marking and Installation Requirements

This lamp module, identified by lens marking E24 5850 and the logo was manufactured to comply with ECE Regulation 23 Category R for Reversing Lamps.

- A tolerance of ± 3 degrees applies on all mounting details.
 - Lamp module mounting plane must be vertical to the ground.
 - Lamp module reference axis must be parallel to the vehicle longitudinal axis.
 - Lamp module centre line must be horizontal (P/N 2ZR 980 605-0xx and 2ZR 980 605-2xx) or vertical (P/N 2ZR 980 605-5xx and 2ZR 980 605-7xx) to the ground.
 - Lamp is approved to be mounted only with lens engraving "TOP" located correctly.
 - Lamp module must be visible from 45° inboard and outboard, as well as from 15° above and 5° below the horizontal axis.
 - At least one lamp is required. Two lamps required for vehicles longer than 6000 mm.
 - Lamps must not be mounted less than 250 mm and more than 1200 mm above the ground.
- Please refer to ECE Regulation 48, for further details.

Note: Lamp does not include a reflex reflector.

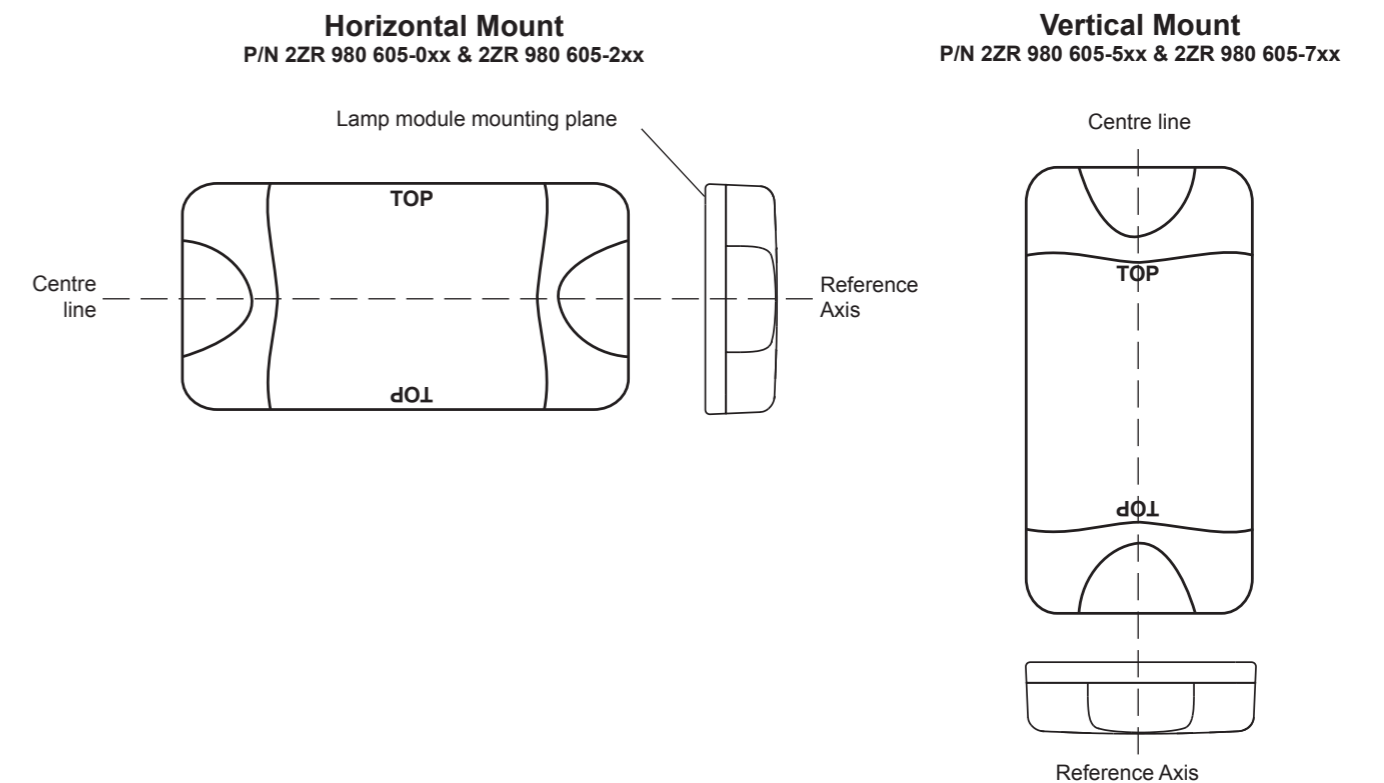



Lamp Mounting Instruction

Screw Cap Removal

Carefully insert a small flat blade screwdriver between the cap and the lens and pull towards the lens, the cap will clip off.

To install the cap push in by hand until the top is flush with the lens.

Surface Mounting

- Drill two holes up to 6.5mm Ø at 148mm centres.
- 6mm Ø screws or bolts are recommended to mount the lamp using the mounting bushes provided.
- Lamp should be mounted on a flat surface.
- If passing the cable through a hole, ensure there are no sharp edges to cut or chafe the cable.
- Alternatively, cable can be routed through the end of the base.
- Connect cable as per chart below.
- Clip the screw caps on securely until flush with the lamp surface

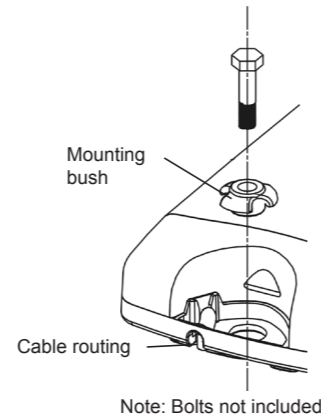

Note: When mounting lamp units side by side allow a gap of 5mm to ensure screw cap removal.

General Dimensions (in millimetres)

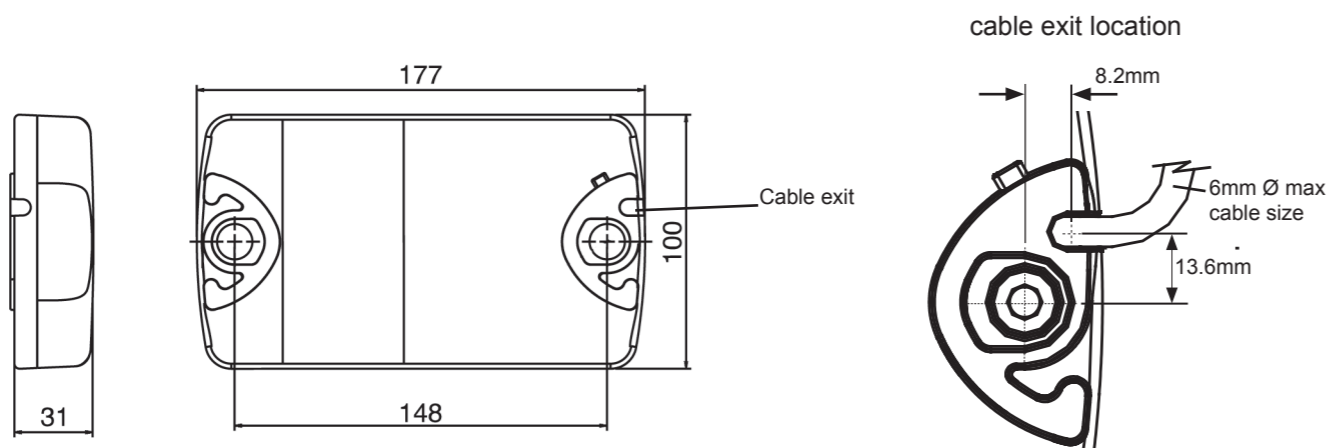

Wiring Colour Coding

Lamp is polarity conscious. The reversal of the polarity will not damage this product but will inhibit its function.

HELLA recommends wire connections be soldered, and heat shrink tubing applied to seal the joint.

Colour	Connect to	Power Consumption
White	Negative (-)	-
Yellow	Reverse (+)	4 watts

NB: Lamp must be protected by a fuse rated at 5 amperes maximum.

Important Notes for Installer and Vehicle Owner



Introduction

LED signal and marker lamps offer many advantages over conventional bulb lamps. Significantly reduced power consumption, ultra long life and high tolerance to shock and vibration make the LED lamps the ideal choice for the commercial transport industry, where the cost of ownership versus the initial purchase price of the product is well understood.

Compatibility to existing electrical systems

It is important for the installer to ascertain the compatibility of the low power consumption LED lamps with the electrical and/or electronic systems of the complete vehicle, including trailers. In most cases the reduced power consumption is beneficial by imposing less demands on the entire electrical system.

For certain functions some electrical systems rely on a set power consumption for monitoring whether, for example, a trailer is connected.

Operation of this lamp using alternating current or modulated direct voltage will cause premature light failure. HELLA recommends connecting ADR or ECE certified Multivolt LED signal and marker lamps to a continuous (unmodulated) 12V or 24V power supply to ensure safe light operation.

Electromagnetic Compatibility (EMC)

This LED lamp is an electronic device. The electrical circuits contain components that suppress possible interference, both emission as well as susceptibility, to the limits prescribed in UNECE Vehicle Regulation No. 10.

To avoid false signals or interference, it is standard practice that sensitive instrumentation such as ABS and Tachometers etc. are provided with direct earths.

Protection against damage due to voltage spikes

This LED lamp is protected against damage from positive voltage spikes caused by events such as load dump conditions up to severity level 3 of ISO 7637-2 and contains a Transient Voltage Suppressor (TVS) designed to withstand a pulse of up to 5000 Watts.

The lamp is protected against reverse polarity connection and negative voltage spikes of up to 1000 volts.

Electric Welding

Electric Welding may damage the LED lamps. For LED lamps, HELLA recommends the negative connection to be wired isolated from the vehicle chassis. If the lamp uses the chassis as the earth return it is recommended that this earth return is disconnected during electric welding.

FIT AND FORGET - BY DESIGN

Congratulations, the product you have selected comes from **HELLA** - a world leader in LED lighting design.



Following the launch of the first LED automotive signal lamps in 1990, **HELLA** Design and Innovation continues to set new standards. **HELLA** innovative solutions have been incorporated into millions of lamps, engineered and tested to the most stringent standards, to suit the most demanding environmental conditions.

The cornerstone to the success of our products is our no compromise **Fit and Forget - by Design** philosophy which is incorporated into every step of the product life cycle.

In a world consuming finite resources at an ever faster rate, **Fit and Forget - by Design** is the right environmental choice that also makes perfect economic sense to customers that consider the total life cycle

For general comments about Hella's products please contact us on E-mail at techfeedback@hella.co.nz



Hella New Zealand

Type / Typbezeichnung: **2ZR 980 605**

1 / 3

Belongs to approval no:
Gehört zur Gen.-Nr.:

E24 5850

Mounting instruction no:
Einbauanweisung Nr.:

Reversing Lamp for automobile (horizontal and vertical version)
Rückfahrscheinwerfer für Kraftfahrzeuge (horizontale und vertikale Version)

Light source:

Lichtquelle:

Reversing Lamp 24 non replaceable light emitting diode
Rückfahrscheinwerfer 24 nicht austauschbare LED's

Design voltage: 13,5 or 28 V **Supply voltage:** 9V to 33V **Nominal power:** 4W
Prüfspannung: Versorgungsspannung: Nennleistung:

- ⊠ = Centre of reference in accordance with the ECE-regulation-no. 23.
Bezugspunkt nach der ECE-Regelung Nr. 23.
 - ⊠ = Centre of reference for the definition for illuminating surface in accordance with the Council Directive 76/756EEC or ECE-regulation-No. 48 (see Annex A).
Bezugspunkt zur Bestimmung der Grenzen der leuchtenden Fläche nach 76/756 EEC oder ECE Regelung-Nr.48.
Markierung s. auf der Abschluss-Scheibe. Maße s. Anlage A.
- Axis of reference:** Parallel to the car center line and parallel to the road.
Bezugsachse: Parallel zur Fahrzeuglängsachse und parallel zur Fahrbahn.

The device must be surface-mounted or flush-fitted according to the enclosed surface-mounting or flush fitting documents (e. g. sketch).

Der An- bzw. Einbau der Geräte hat nach anliegenden An- bzw. Einbauunterlagen (z. B. Skizze und Anlage A) zu erfolgen.

2008-04-29

E24 23R-005850



Hella New Zealand

Type / Typbezeichnung: **2ZR 980 605**

Version A

2 / 3

Belongs to approval no:
Gehört zur Gen.-Nr.:

E24 5850

Mounting instruction no:
Einbauanweisung Nr.:

Reversing Lamp for automobile (horizontal version)
Rückfahrscheinwerfer für Kraftfahrzeuge (horizontale Version)

The Lamp can be mounted also rotated 180°.

Das Gerät darf 180°gedreht angebaut werden.

Front - View

Ansicht von vorne

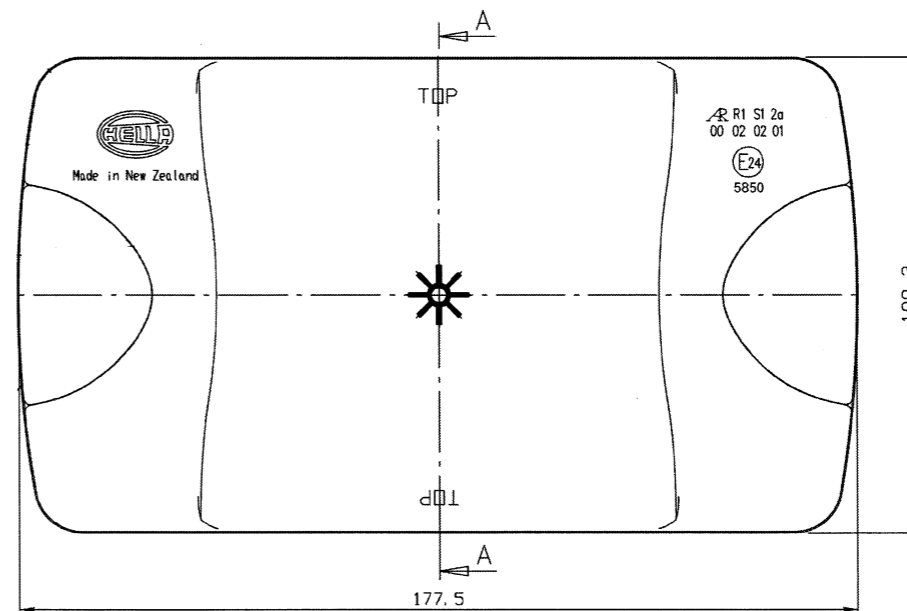

Side - View / Section A-A

Ansicht von der Seite / Schnitt A-A

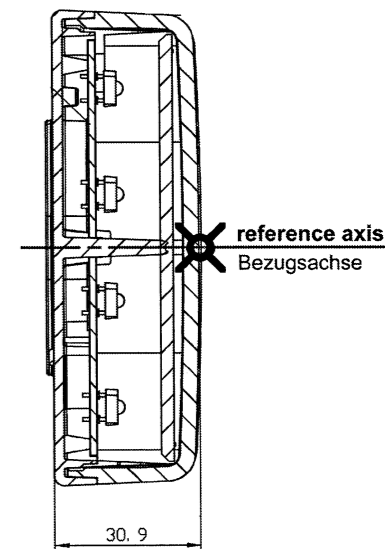

Back - View

Ansicht von Hinten

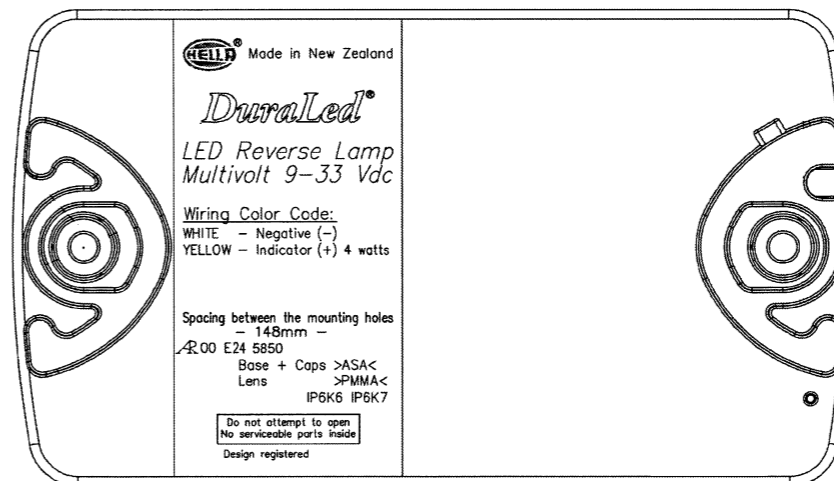

The device must be surface-mounted or flush-fitted according to the enclosed surface-mounting or flush fitting documents (e. g. sketch).

Der An- bzw. Einbau der Geräte hat nach anliegenden An- bzw. Einbauunterlagen (z. B. Skizze und Anlage A) zu erfolgen.

2008-04-29

E24 23R-005850



Hella New Zealand

Type / Typbezeichnung: **2ZR 980 605**

Version **B**

3 / 3

Belongs to approval no: **E24 5850**
Gehört zur Gen.-Nr.:

Mounting instruction no:
Einbauanweisung Nr.:

Reversing Lamp for automobile (vertical version)
Rückfahrcheinwerfer für Kraftfahrzeuge (vertikale Version)

The Lamp can be mounted also rotated 180°.
Das Gerät darf 180° gedreht angebaut werden.

Front - View

Ansicht von vorne

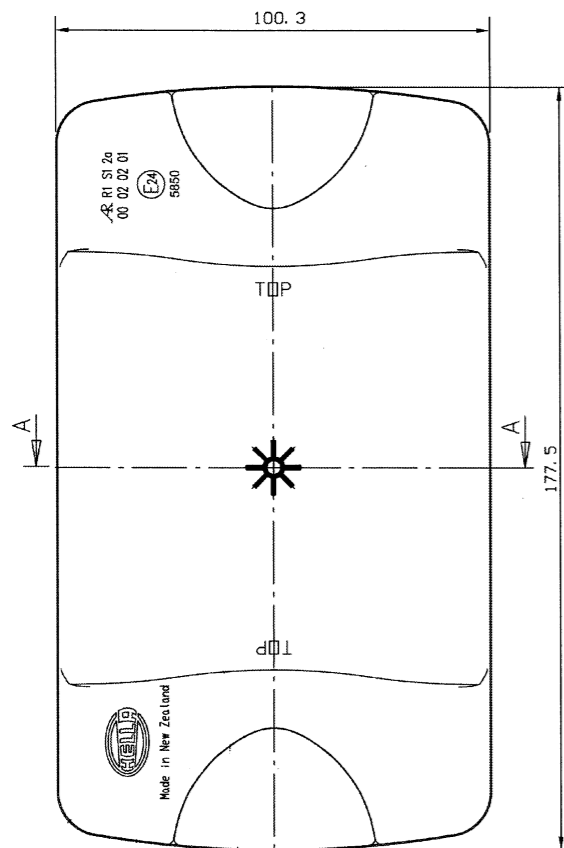

Back - View

Ansicht von Hinten

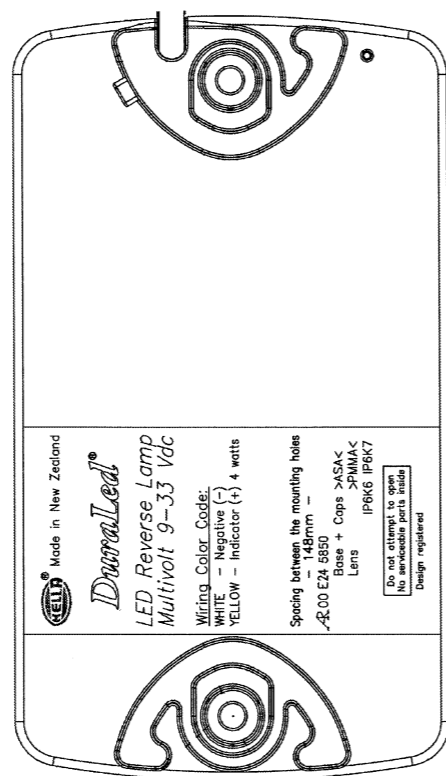

Top - View / Section A-A

Ansicht von oben / schnitt A-A

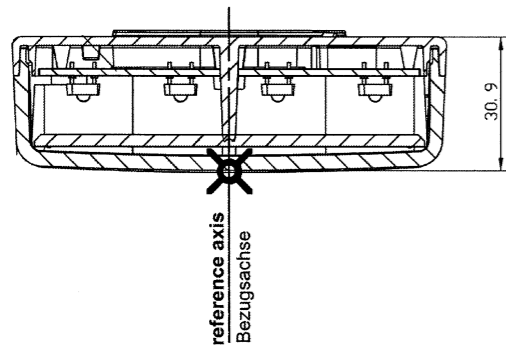

The device must be surface-mounted or flush-fitted according to the enclosed surface-mounting or flush fitting documents (e. g. sketch).

Der An- bzw. Einbau der Geräte hat nach anliegenden An- bzw. Einbauunterlagen (z. B. Skizze und Anlage A) zu erfolgen.

2008-04-29

E24 23R-005850



Hella New Zealand

Type: **2ZR 980 605**
Typbezeichnung:

Annex **A**
Anlage A

Belongs to approval no.: **E24 5850**
Gehört zur Gen. Nr.:

Mounting Instruction no.:
Einbauanweisung Nr.:

Determining the borders of the illuminated area of lamp in accordance with the Directives of the Council of the European Community on "Mounting of lamps and light signalling equipment" 76/756 EEC and ECE-Regulation No. 48, sub-section 2.9.2..

Bestimmung der Grenzen der leuchtenden Fläche einer Leuchte gemäß den Richtlinien des Rates der Europäischen Gemeinschaften "Anbau von Beleuchtungs- und Lichtsignaleinrichtung" nach 76/756/EWG, bzw. ECE-Regelung Nr. 48, Absatz 2.9.2..

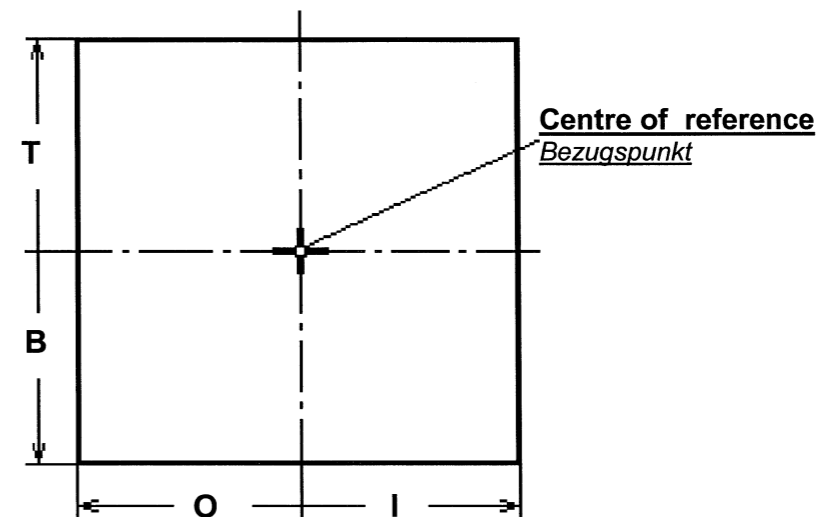

Category of Lamp Gerätebezeichnung	Top edge Obere Grenze (T) mm	Bottom edge Untere Grenze (B) mm	Outer edge Äußere Grenze (O) mm	Inner edge Innere Grenze (I) mm
Reversing Lamp (Horizontal Mounting) Rückfahrcheinwerfer (Horizontaler Anbau)	42	42	39	39
Reversing Lamp (Vertical Mounting) Rückfahrcheinwerfer (Vertikaler Anbau)	40	40	39	39

2008-04-29

E24 23R-005850