

## HEAVY-DUTY COMMERCIAL TRANSPORT JUNCTION BOX

Heavy-duty durable reinforced junction box which offers significant benefits to the commercial transport operator.

### Mounting Instructions

- Remove lid (2) and internal plate (4) from junction box.
- Drill Ø6mm holes in the base as required and use the base (5) as a template for the mounting holes (see diagram 2).

Note: The box should be mounted vertically on a flat surface with the grommets (6) pointing down, and be protected from heavy water splashes and road debris. The drain hole and the sealing gasket joint must be positioned at the bottom of the box (see diagram 2).

- Components, such as fuse boxes, relays and connectors may be mounted on the internal plate by using self tapping screws.
- Use only the supplied screws to mount the internal plate to the base.
- Ensure sealing O-ring (3) is correctly located on the lip surrounding the screw hole in the centre of the under side of the lid before re-assembly.
- No tools are required to secure the lid, only finger pressure is necessary to tighten the centre bolt (1).
- If required extra glands may be fitted to the junction box as indicated (see diagram 2).

Diagram 1

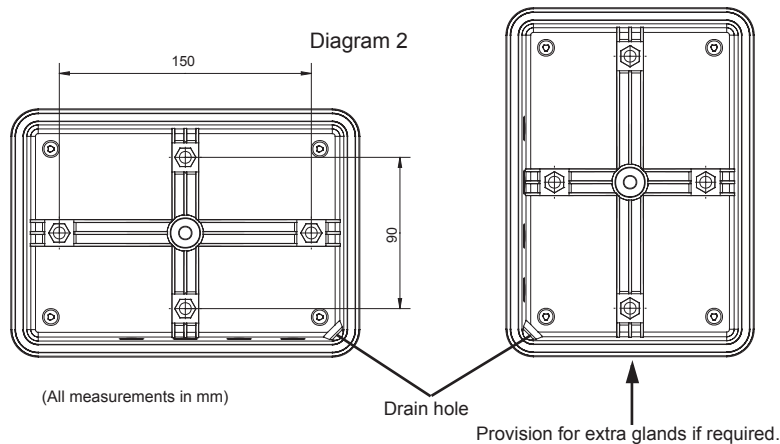
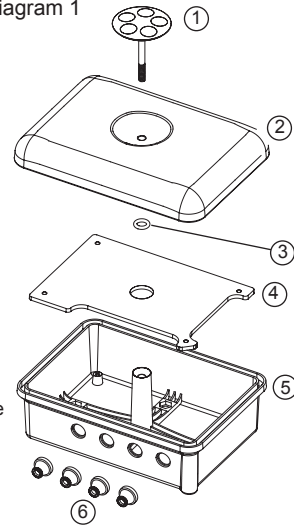

## HEAVY-DUTY COMMERCIAL TRANSPORT JUNCTION BOX

Heavy-duty durable reinforced junction box which offers significant benefits to the commercial transport operator.

### Mounting Instructions

- Remove lid (2) and internal plate (4) from junction box.
- Drill Ø6mm holes in the base as required and use the base (5) as a template for the mounting holes (see diagram 2).

Note: The box should be mounted vertically on a flat surface with the grommets (6) pointing down, and be protected from heavy water splashes and road debris. The drain hole and the sealing gasket joint must be positioned at the bottom of the box (see diagram 2).

- Components, such as fuse boxes, relays and connectors may be mounted on the internal plate by using self tapping screws.
- Use only the supplied screws to mount the internal plate to the base.
- Ensure sealing O-ring (3) is correctly located on the lip surrounding the screw hole in the centre of the under side of the lid before re-assembly.
- No tools are required to secure the lid, only finger pressure is necessary to tighten the centre bolt (1).
- If required extra glands may be fitted to the junction box as indicated (see diagram 2).

Diagram 1

