



Contents

SAE Compliant LED Lamps

EuroLED Series.....	54
110mm Round LED Lamps.....	54 - 55
DuraLED Series.....	56 - 57
DuraLED Surface Mount Marker Lamps.....	58
Recess Mount Clearance Lamps.....	59
Centre High Mount Stop Lamps.....	60 - 61
LED Daytime Running Lamps.....	62 - 63
LED DRL/PO Control Unit.....	63
SAE Compliant List.....	64

EuroLED Stop/Tail/Rear Turn Signal Lamp

Low profile LED stop/tail/turn signal lamps with single LED. The use of precision optics enable a single high intensity LED to be used for the first time in a commercial vehicle lamp, resulting in low power consumption.

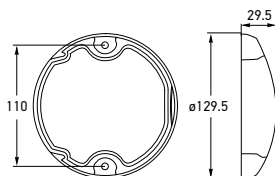

Part Number	2SB 959 821-301	BLACK COVER
	2SB 959 821-311	WHITE COVER
Mounting	Two hole surface mount with mounting bushes supplied.	
Voltage	Multivolt for optimum brightness at input voltages from 9 to 33 volts.	
Power Consumption	Stop/Rear turn: 2.5W Tail: 0.5W	
Protection	Reverse polarity and 1500 watt Transient Voltage Suppressor (TVS) IP 6K6 (Protection against dust and high pressure water jets) IP 6K7 (Protection against dust and temporary water immersion)	
Cable Length	Pre-wired with 2.5m of sheathed multi-core cable.	
Approval Markings	SAE S2 T2 I6 05 DOT	

EuroLED Reversing Lamp

Low profile LED reversing lamp with single LED and clear lens.

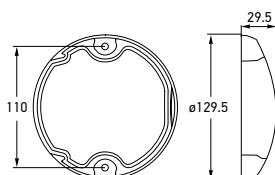

Part Number	2ZR 959 820-201	BLACK COVER
	2ZR 959 820-211	WHITE COVER
Power Consumption	2.5W	
Approval Markings	SAE R 05 DOT	
Other specifications as per P/N 2SB 959 821-3xx.		

110mm Round LED Stop/Tail/Rear Turn Signal Lamp

LED lamps for commercial transport, buses, caravans and trailers. Featuring low power consumption and Multivolt circuitry ensuring full light output from 9 to 33 volts.



2SB 959 931-801

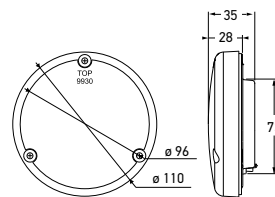

Part Number	2SB 959 931-841	CHROME BASE
	2SB 959 931-831	BLACK BASE
	2SB 959 931-801	MODULE
Mounting	Mounting only with lens engraving "TOP" located correctly.	
Voltage	Multivolt for optimum brightness at input voltages from 9 to 33 volts.	
Power Consumption	Stop/Rear turn: 3W	Tail: 1W
Protection	Reverse polarity and 1500 watt Transient Voltage Suppressor (TVS) Sealed against dust and water ingress.	
Cable Length	Pre-wired with 200mm of cable.	
Approval Markings	SAE I6 S2 T2 06 DOT	
Module image and diagram shown.		

SAE COMPLIANT LED LAMPS

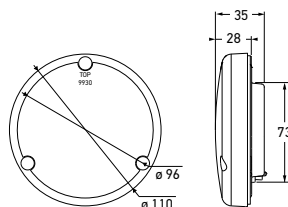

110mm Round LED Front Turn Signal Lamp

Low profile LED front turn signal lamp specifically designed for commercial transport applications. Features high-intensity LEDs and high impact acrylic lens for superior light output and impact resistance.

Part Number	2BA 959 932-421	CHROME BASE
	2BA 959 932-411	BLACK BASE
	2BA 959 932-401	MODULE

Mounting	Mounting only with lens engraving "TOP" located correctly.
Voltage	Multivolt for optimum brightness at input voltages from 9 to 33 volts.
Power Consumption	4W
Protection	Reverse polarity and 1500 watt Transient Voltage Suppressor (TVS) Sealed against dust and water ingress.
Cable Length	Pre-wired with 200mm of cable.
Approval Markings	SAE I6 08 DOT

Clear lens or pendant mount is also available. Module image and diagram shown.



2BA 959 932-401

SAE COMPLIANT LED LAMPS

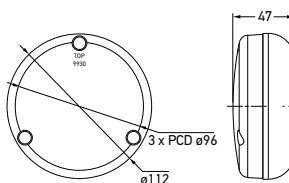

110mm Round LED Rear Turn Signal Lamp

Low profile LED rear turn signal lamp specifically designed for commercial transport applications.

Part Number	2BA 959 932-841	CHROME BASE
	2BA 959 932-831	BLACK BASE
	2BA 959 932-801	MODULE

Power Consumption	3W
Approval Markings	SAE I6 06 DOT

Other specifications as per P/N 2BA 959 932-4xx. Black base image and diagram shown.



2BA 959 932-831

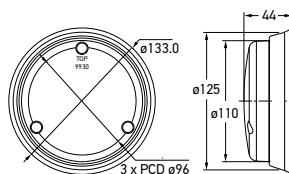

110mm Round LED Reversing Lamp

Low profile LED reversing lamp specifically designed for commercial transport applications.

Part Number	2ZR 959 930-841	CHROME BASE
	2ZR 959 930-831	BLACK BASE
	2ZR 959 930-801	MODULE

Power Consumption	5W
Approval Markings	SAE R 06 DOT

Other specifications as per P/N 2BA 959 932-4xx. Chrome base image and diagram shown. Reversing lamp is not designed for continuous use.



2ZR 959 930-841

DuraLED Stop/Tail/Rear Turn Signal Lamp

Durable rear lamps for trucks, buses, caravans and trailers, featuring polycarbonate lens, low power consumption and Multivolt circuitry ensuring full light output from 9 to 33 volts. The lamps are fully sealed against dust and moisture.

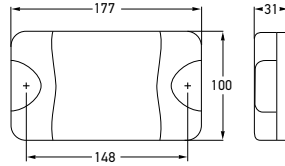

Part Number	2SB 959 060-301	2SB 959 060-307 (Pack of 4)
Mounting	Suitable for horizontal or vertical mounting. Two hole surface mount with mounting bushes supplied.	
Voltage	Multivolt for optimum brightness at input voltages from 9 to 33 volts.	
Power Consumption	Stop/Rear turn: <8W Tail: 2W	
Protection	Reverse polarity and 5000 watt Transient Voltage Suppressor (TVS) IP 6K6 (Protection against dust and high pressure water jets) IP 6K7 (Protection against dust and temporary water immersion)	
Cable Length	Pre-wired with 2.5m of sheathed multi-core cable.	
Approval Markings	SAE S2 T2 I6 99 DOT	

SAE COMPLIANT LED LAMPS





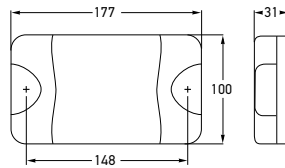
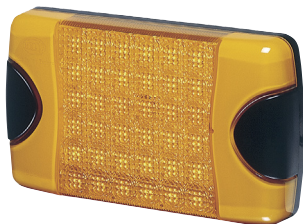

DuraLED Rear Turn Signal Lamp

Durable rear lamps for trucks, buses, caravans and trailers, featuring polycarbonate lens, low power consumption and Multivolt circuitry ensuring full light output from 9 to 33 volts. The lamps are fully sealed against dust and moisture.



Part Number	2BA 959 070-301	2BA 959 070-307 (Pack of 4)
Mounting	Suitable for horizontal or vertical mounting. Two hole surface mount with mounting bushes supplied.	
Voltage	Multivolt for optimum brightness at input voltages from 9 to 33 volts.	
Power Consumption	<8W	
Protection	Reverse polarity and 5000 watt Transient Voltage Suppressor (TVS) IP 6K6 (Protection against dust and high pressure water jets) IP 6K7 (Protection against dust and temporary water immersion)	
Cable Length	Pre-wired with 2.5m of sheathed multi-core cable.	
Approval Markings	SAE I6 99 DOT	

SAE COMPLIANT LED LAMPS

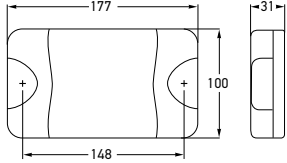
     		
Part Number	2SB 959 060-331	2SB 959 060-337 (Pack of 12)
Mounting	Suitable for horizontal or vertical mounting. Two hole surface mount with mounting bushes supplied.	
Voltage	12V DC	
Power Consumption	Stop/Rear turn: <8W Tail: 2W	
Protection	Reverse polarity and 5000 watt Transient Voltage Suppressor (TVS) IP 6K6 (Protection against dust and high pressure water jets) IP 6K7 (Protection against dust and temporary water immersion)	
Cable Length	180mm cable terminated with a Deutsch connector (part number DTM04-3P)	
Approval Markings	SAE S2 T2 I6 99 DOT	





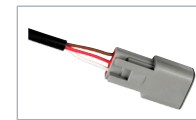

DuraLED Stop/Tail/Rear Turn Signal Lamp with Deutsch Connector - 12 Volt

Durable rear lamps for trucks, buses, caravans and trailers, featuring polycarbonate lens and low power consumption. The lamps are fully sealed against dust and moisture.



Deutsch connector

SAE COMPLIANT LED LAMPS

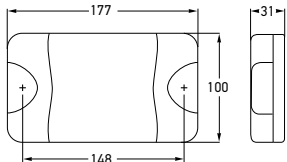
     		
Part Number	2BA 959 070-331	2BA 959 070-337 (Pack of 12)
Mounting	Suitable for horizontal or vertical mounting. Two hole surface mount with mounting bushes supplied.	
Voltage	12V DC	
Power Consumption	<8W	
Protection	Reverse polarity and 5000 watt Transient Voltage Suppressor (TVS) IP 6K6 (Protection against dust and high pressure water jets) IP 6K7 (Protection against dust and temporary water immersion)	
Cable Length	180mm cable terminated with a Deutsch connector (part number DTM04-2P)	
Approval Markings	SAE I6 99 DOT	

DuraLED Rear Turn Signal Lamp with Deutsch Connector - 12 Volt

Durable rear lamps for trucks, buses, caravans and trailers, featuring polycarbonate lens and low power consumption. The lamps are fully sealed against dust and moisture.

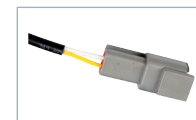

Deutsch connector

**DuraLED Surface Mount
Side Marker, Clearance and
Identification Lamp**

Surface mount side marker, clearance and identification lamp with clear, high impact acrylic lens. Pack of 16 lamps.



2PS 959 660-407

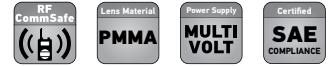
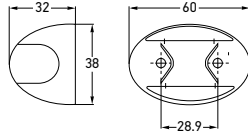

Part Number	2PS 959 660-207	AMBER
	2PS 959 660-407	RED
Mounting	Suitable for horizontal mounting only.	
Voltage	Multivolt for optimum brightness at input voltage from 8 to 28 volts.	
Power Consumption	<1W	
Protection	Reverse polarity protection. IP 6K6 (Protection against dust and high pressure water jets) IP 6K7 (Protection against dust and temporary water immersion)	
Cable Length	Pre-wired with 500mm of sheathed multi-core cable.	
Approval Markings	SAE P2 P3 99 DOT	
Spare Parts	9BG 959 565-007	Black shroud
	9BG 959 565-017	White shroud
	9BG 959 565-037	Red shroud
	9BG 959 565-047	Yellow shroud
	9BG 959 565-057	Green shroud
	9BG 959 565-067	Blue shroud
	9BG 959 565-077	Amber shroud
	9BG 959 565-407	Chrome plated shroud

Coloured shroud - Pack of 4

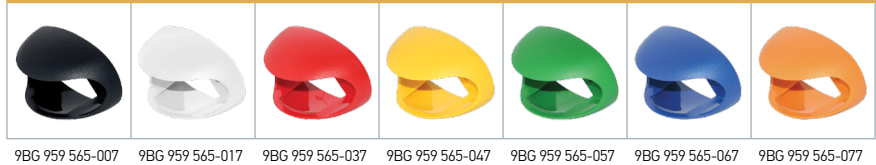

9BG 959 565-007 9BG 959 565-017 9BG 959 565-037 9BG 959 565-047 9BG 959 565-057 9BG 959 565-067 9BG 959 565-077



9BG 959 565-407

SAE COMPLIANT LED LAMPS

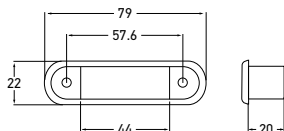

Part Number	12 VOLT	24 VOLT	
	2PF 959 653-007	2PF 959 653-107	CLEAR PMMA LENS
	2PF 959 653-207	2PF 959 653-307	AMBER PMMA LENS
	2PF 959 653-507		CLEAR PC LENS
	2PF 959 653-707		AMBER PC LENS
Mounting	Suitable for horizontal mounting.		
Power Consumption	<1W		
Protection	Reverse polarity protection. IP 6K6 (Protection against dust and high pressure water jets) IP 6K7 (Protection against dust and temporary water immersion)		
Cable Length	Pre-wired with 500mm of sheathed multi-core cable.		
Approval Markings	SAE P3 04 DOT		

LED Front Clearance Side Marker and Identification Lamp

Recess mount, amber, front clearance side marker and identification lamp featuring an amber or clear lens in either high impact acrylic, or polycarbonate. Lamps are fully sealed against dust and moisture ingress. Pack of 30 lamps.



2PF 959 653-207

SAE COMPLIANT LED LAMPS

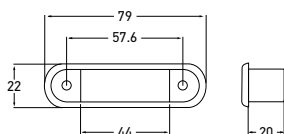

Part Number	12 VOLT	24 VOLT	
	2XA 959 657-007	2XA 959 657-107	CLEAR LENS
	2XA 959 657-207	2XA 959 657-307	RED LENS
Mounting	Suitable for horizontal mounting.		
Power Consumption	<1W		
Protection	Reverse polarity protection. IP 6K6 (Protection against dust and high pressure water jets) IP 6K7 (Protection against dust and temporary water immersion)		
Cable Length	Pre-wired with 500mm of sheathed multi-core cable.		
Approval Markings	SAE P3 04 DOT		

LED Rear Clearance Side Marker and Identification Lamp

Recess mount, red, rear clearance side marker and identification lamp featuring a red or clear lens in high impact acrylic. Lamps are fully sealed against dust and moisture ingress. Pack of 30 lamps.



2XA 959 657-207

LED Spoiler Centre High Mount Stop Lamp

Spoiler or exterior mounted 12 LED centre high mount stop lamp, available with a red or clear lens. Pack of 10 lamps.

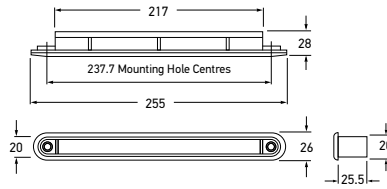

2DA 959 071-577

2DA 959 071-757 (Wide rim)

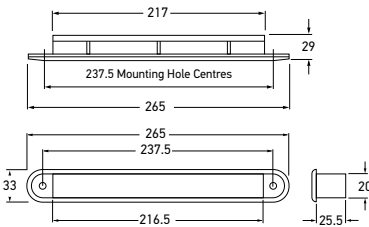

Wide rim diagram shown.

Part Number	12 VOLT	24 VOLT	CLEAR LENS	
	2DA 959 071-077	2DA 959 071-277		RED LENS
	2DA 959 071-577	2DA 959 071-777		
	2DA 959 071-757 (Wide Rim)			
Mounting	Suitable for horizontal mounting only. Two hole recess mount.			
Power Consumption	2W			
Protection	Reverse polarity protection. IP 6K7 (Protection against dust and temporary water immersion) IP 6K9K (Protection against dust and high pressure/steam jet cleaning)			
Cable Length	Pre-wired with 2.5m of sheathed multi-core cable.			
Approval Markings	E4 02 7547 SAE U3 97 DOT			
CCC marked versions are available upon request.				

LED Spoiler Centre High Mount Stop Lamp - 12 Volt

Spoiler mounted 12 LED centre high mount stop lamp, available with a red or clear high impact acrylic lens.

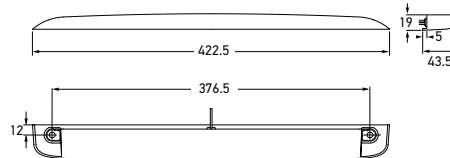

2DA 959 580-551

Part Number	2DA 959 580-151	RED LENS
	2DA 959 580-551	CLEAR LENS
Mounting	Suitable for horizontal mounting only.	
Voltage	12V DC	
Power Consumption	<3W	
Protection	Reverse polarity protection.	
Cable Length	Pre-wired with 3.5m of cable.	
Approval Markings	E4 02 7587 SAE U3 02 DOT	

SAE COMPLIANT LED LAMPS

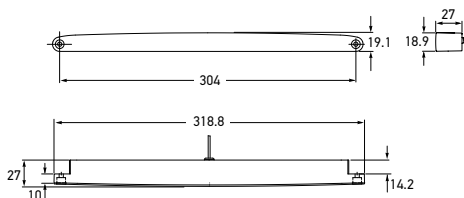

LED Spoiler Centre High Mount Stop Lamp - 12 Volt

Spoiler mounted 12 LED centre high mount stop lamp, available with a red or clear polycarbonate lens.



Part Number	2DA 959 474-xx7	RED LENS
Mounting	Suitable for horizontal mounting only.	
Voltage	12V DC	
Power Consumption	<3W	
Protection	Reverse polarity protection.	
Cable Length	Cable lengths available on request.	
Approval Markings	SAE U2 U3 98 DOT	
Please contact your local HELLA representative for further details about these lamps.		

SAE COMPLIANT LED LAMPS

LED Daytime Running Lamps - 0°

Forward facing signal lamps, designed to be mounted on vehicles with flat fronts, or on motorbikes. The lamps are an Easy-Fit installation, usually requiring no extra parts. Once the wiring is complete and the bracket is fitted, the LED lamp easily clips into place and installation is complete.

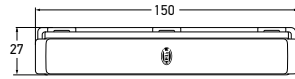

Part Number	LAMP MODULE		KIT	
		2PT 980 970-021	2PT 980 970-821	12 VOLT
		2PT 980 970-521	2PT 980 970-871	24 VOLT
Mounting	Suitable for horizontal mounting only.			
Power Consumption	2W			
Protection	Reverse polarity protection. IP 6K7 (Protection against dust and temporary water immersion) IP 6K9K (Protection against dust and high pressure/steam jet cleaning).			
Cable Length	Single lamps are pre-wired with 2.5m of sheathed multi-core cable. Lamps supplied with kit are pre-wired with 2.8m of sheathed multi-core cable.			
Spare Parts	8HG 980 875-101 5DF 980 816-051 5DF 980 816-551	Brackets (LH/RH) LED DRL/PO Control Unit (12 Volt) LED DRL/PO Control Unit (24 Volt)		
Approval Markings	E24 5875	SAE P 14 DOT DRL		
Kit Contents	2PT 980 970-821/...-871 2 x LED daytime running lamps 2 x Mounting brackets 6 x Mounting screws 1 x Changeover relay 1 x Instruction sheet 10 x Cable ties 4 x Accessory cable looms			

LED Daytime Running Lamps - 15°

A lens angle of 15 degrees allows installation as close as possible to the corners of a modern motor vehicle. These lamps were designed to fit the curved bumpers of modern vehicles to give the look of Original Equipment fitment. The lamps have extremely low power consumption at 2W per lamp and high impact acrylic lenses to protect against impact damage.

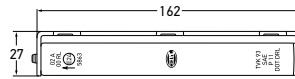

Part Number	LAMP MODULE		KIT	
		2PT 980 860-001	2PT 980 860-801	12 VOLT
		2PT 980 860-501	2PT 980 860-851	24 VOLT
Mounting	Suitable for horizontal mounting only.			
Power Consumption	2W			
Protection	Reverse polarity protection. IP 6K7 (Protection against dust and temporary water immersion) IP 6K9K (Protection against dust and high pressure/steam jet cleaning).			
Cable Length	Single lamps are pre-wired with 2.5m of sheathed multi-core cable. Lamps supplied with kit are pre-wired with 2.8m of sheathed multi-core cable.			
Spare Parts	8HG 980 864-101 5DF 980 816-001 5DF 980 816-501	Brackets (LH/RH) LED DRL/PO Control Unit (12 Volt) LED DRL/PO Control Unit (24 Volt)		
Approval Markings	E24 5863	SAE P 11 DOT DRL		
Kit Contents	2PT 980 860-801/...-851 2 x LED daytime running lamps 2 x Mounting brackets 6 x Mounting screws 1 x Changeover relay 1 x Instruction sheet 10 x Cable ties 4 x Accessory cable looms			

SAE COMPLIANT LED LAMPS

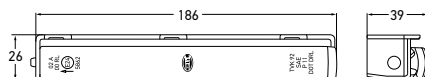

Part Number	LAMP MODULE	KIT	
		2PT 980 850-001	2PT 980 850-801
	2PT 980 850-501	2PT 980 850-851	24 VOLT

Mounting	Suitable for horizontal mounting only.		
Power Consumption	2W		
Protection	Reverse polarity protection. IP 6K7 (Protection against dust and temporary water immersion) IP 6K9K (Protection against dust and high pressure/steam jet cleaning).		
Cable Length	Single lamps are pre-wired with 2.5m of sheathed multi-core cable. Lamps supplied with kit are pre-wired with 2.8m of sheathed multi-core cable.		
Spare Parts	8HG 980 854-101 5DF 980 816-001 5DF 980 816-501	Brackets (LH/RH) LED DRL/PO Control Unit (12 Volt) LED DRL/PO Control Unit (24 Volt)	
Approval Markings	E24 5862	SAE P 11 DOT DRL	
Kit Contents	2PT 980 850-801/...-851 2 x LED daytime running lamps 2 x Mounting brackets 6 x Mounting screws 1 x Changeover relay 1 x Instruction sheet 10 x Cable ties 4 x Accessory cable looms		

LED Daytime Running Lamps - 30°

A lens angle of 30 degrees allows installation as close as possible to the corners of a modern motor vehicle. These lamps were designed to fit the curved bumpers of modern vehicles to give the look of Original Equipment fitment. The lamps have extremely low power consumption at 2W per lamp and high impact acrylic lenses to protect against impact damage.



SAE COMPLIANT LED LAMPS

LED DRL/PO Control Unit

A control unit that dims the light output of LED daytime running lamps to front position/park function level.

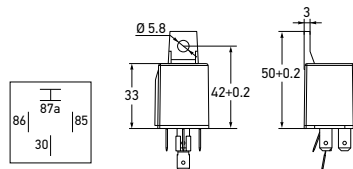

Part Number	12 VOLT	24 VOLT	
	5DF 980 816-001	5DF 980 816-501	15° AND 30°
5DF 980 816-051	5DF 980 816-551	0°	

Requirement One unit is required per pair of LED daytime running lamps.



RECOMMENDED INSTALLATION DIAGRAM FOR WIRING	WIRING SPECIFICATIONS										
	<table border="1"> <thead> <tr> <th>Terminal Number</th> <th>Connect to</th> </tr> </thead> <tbody> <tr> <td>30</td> <td>Ignition (+)</td> </tr> <tr> <td>85</td> <td>Earth return (-)</td> </tr> <tr> <td>86</td> <td>Front position or headlamps (+)</td> </tr> <tr> <td>87A</td> <td>LED daytime running lamps (+)</td> </tr> </tbody> </table>	Terminal Number	Connect to	30	Ignition (+)	85	Earth return (-)	86	Front position or headlamps (+)	87A	LED daytime running lamps (+)
	Terminal Number	Connect to									
	30	Ignition (+)									
	85	Earth return (-)									
86	Front position or headlamps (+)										
87A	LED daytime running lamps (+)										

Part Number	Function	SAE Regulation Number	SAE Compliance Number
EuroLED Series			
2SB 959 821-3xx	Stop/tail/turn signal lamp for use on motor vehicles 2032mm or more in overall width.	SAE J2261 Jan2002/SAE J2040 Mar2002	SAE S2 T2 I6 05 DOT
2ZR 959 820-2xx	Backup (reversing) lamp	SAE J593 Mar2000	SAE R 05 DOT
110mm Round LED Lamps			
2SB 959 931-8xx	Stop/tail/turn signal lamp for use on motor vehicles 2032mm or more in overall width.	SAE J2261 Jan2002/SAE J2040 Mar2002	SAE I6 S2 T2 06 DOT
2BA 959 932-4xx	Turn signal lamp for use on motor vehicles 2032mm or more in overall width.	SAE J2261 Jan2002 and SAE J1395 Apr1985	SAE I6 08 DOT
2BA 959 932-8xx	Turn signal lamp for use on motor vehicles 2032mm or more in overall width.	SAE J2261 Jan2002 and SAE J1395 Apr1985	SAE I6 06 DOT
2ZR 959 930-8xx	Backup (reversing) lamp	SAE J593 Mar2000	SAE R 06 DOT
DuraLED Series			
2SB 959 060-30x	Stop/tail/turn signal lamp for use on motor vehicles 2032mm or more in overall width.	SAE J1398 May1985/SAE J585e/SAE J1395 Apr1985	SAE S2 T2 I6 99 DOT
2SB 959 060-33x	Stop/tail/turn signal lamp for use on motor vehicles 2032mm or more in overall width.	SAE J1398 May1985/SAE J585e/SAE J1395 Apr1985	SAE S2 T2 I6 99 DOT
2BA 959 070-30x	Turn signal lamp for use on motor vehicles 2032mm or more in overall width.	SAE J2261 Jan2002 and SAE J1395 Apr1985	SAE I6 99 DOT
2SB 959 070-33x	Turn signal lamp for use on motor vehicles 2032mm or more in overall width.	SAE J2261 Jan2002 and SAE J1395 Apr1985	SAE I6 99 DOT
DuraLED Surface Mount Marker Lamps			
2PS 959 660-xxx	Clearance, side marker and identification lamps for motor vehicles 2032mm or more in overall width.	SAE J2042 Jun1996	SAE P2 P3 99 DOT
Recess Mount Front Marker Lamps			
2PF 959 653-xxx	Clearance, side marker and identification lamps for motor vehicles 2032mm or more in overall width.	SAE J2042 May2003	SAE P3 04 DOT
2XA 959 657-xxx	Clearance, side marker and identification lamps for motor vehicles 2032mm or more in overall width.	SAE J2042 May2003	SAE P3 04 DOT
1x12 Centre High Mount Stop Lamp			
2DA 959 071-xxx	Centre high mount stop lamp for vehicles less than 2032mm in overall width.	SAE J186a	SAE U3 97 DOT
470 Series Centre High Mount Stop Lamp			
2DA 959 580-xxx	Centre high mount stop lamp for vehicles less than 2032mm in overall width.	SAE J186a	SAE U3 02 DOT
470 Series Centre High Mount Stop Lamp			
2DA 959 474-xxx	High mount stop lamp for vehicles 2032mm or more in overall width.	SAE J186a and SAE J1432 Oct1988	SAE U2 U3 98 DOT
LED Daytime Running Lamps			
2PT 980 970-xxx	Daytime running lamp and parking lamp	SAE J2087 Mar2006 and SAE J222	SAE P 14 DOT DRL
2PT 980 860-xxx	Daytime running lamp and parking lamp	SAE J2087 Mar2006 and SAE J222	SAE P 11 DOT DRL
2PT 980 850-xxx	Daytime running lamp and parking lamp	SAE J2087 Mar2006 and SAE J222	SAE P 11 DOT DRL