



Headlamps and Inserts

HELLA has manufactured headlamp systems for more than 100 years. The durability and reliability of HELLA products has made HELLA a world leader in headlamp technology.



Contents

Headlamps and Inserts

90mm Universal Headlamps.....	86-87
Semi Sealed Headlamps and Housings - 7" Round.....	88-89
Semi Sealed Headlamps - 5 ¾" Round.....	90-91
Semi Sealed Headlamps and Housings - Rectangular.....	92-93
BMW 3 Series Lamps.....	94
BMW 3 and 5 Series Lamps.....	95
BMW 5 Series Lamps.....	96
BMW 3, 5, and 7 Series Headlamps.....	97
Universal Headlamps/VW Golf MK III-MK IV.....	98
Headlamp Accessories.....	99
5 ¾" Conventional Sealed Beams.....	100
4 ½" Conventional Sealed Beams.....	101

**Bi-LED 90mm Premium LED Module
- 12/24 Volt**

LED dipped/main beam headlamp featuring a generous spread of light and strong main beam for the open road. Low power consumption and ultra long life equates to economical running costs compared to a bulb lamp. Exceptional white light output and extremely homogeneous illumination for reduced driver strain which means greater safety.

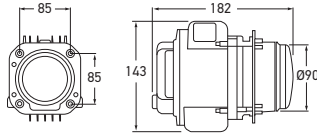

Part Number	1032	
Voltage	Multivolt™ for optimum brightness in 12 and 24 volt systems.	
Power Consumption	Dipped beam:	30W
	Main beam:	60W
Spare Parts	9.1029.11 4983	Mounting frame 3 pole super seal plug set
Compliance	E1 3159	E1 6189

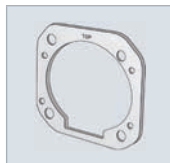

P/N 9.1029.11

HEADLAMPS & INSERTS

H7 Bi-Halogen Headlamp

Compact H7 dipped/main beam headlamp. Pattern-free hardened glass lens and Free-Form (FF) cast aluminium reflector. Excellent light output and extremely homogeneous illumination with virtually no scatter. Straight-forward installation with 3 pre-mounted adjustment screws on the vehicle body.

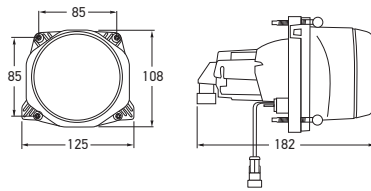

Part Number	1LL 009 998-011	12 VOLT
	1LL 009 998-051	24 VOLT
Bulbs to Suit	12V 24V	CA1255 CA2470
Spare Parts	9.1029.11 9.1534.05	Mounting frame Bulb connector
Compliance	E1 2484	



P/N 9.1029.11

P/N 9.1534.05

Headlamp Adjusters

Adjuster to suit 90mm headlamps.



Part Number	15297700 (Pack of 3)		H7 HEADLAMPS
	25416300 (Pack of 3)		H1 HEADLAMPS
To Suit	P/N 15297700 P/N 25416300	H7 P/Ns 1029-24V and 1030-24V P/Ns 1029H1-24V and 1030H1-24V	



P/N 25416300

HEADLAMPS AND INSERTS

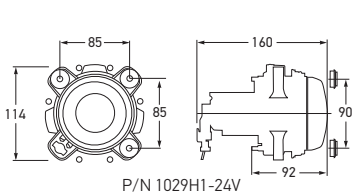

P/N 1029H1-24V

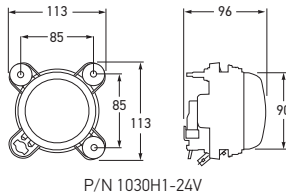

P/N 1030H1-24V

H1 Headlamp - 24 Volt

H1 headlamps with die cast aluminium reflector and hardened glass lens.



Part Number	1029H1-24V	DIPPED BEAM	
	1030H1-24V	MAIN BEAM	
Bulbs to Suit	12V	24V	
	Dipped/Main beam:	C1255	C2470
	Position:	HL124	HL244
Spare Parts	9GH 152 654-007	Rear cap	
	8JD 156 150-807 9.1029.10	Two pole plug with terminals and seals Mounting frame	
Compliance	Ei 2397		



P/N 9.1029.10



P/N 8JD 156 150-807



P/N 1030H1-24V

HEADLAMPS & INSERTS

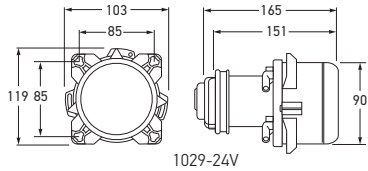

1029-24V

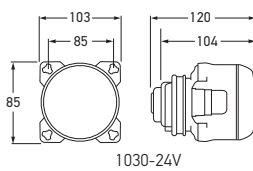

1030-24V

H7 Headlamp - 24 Volt

Compact H7 headlamps with glass lens for buses, coaches and mobile homes. Includes headlamp adjusters.



Part Number	1029-24V	DIPPED BEAM	
	1030-24V	MAIN BEAM	
Bulbs to Suit	12V	24V	
	Dipped/Main beam:	CA1255	CA2470
	Position:	HL124	HL244
Spare Parts	9GH 152 654-007	Rear cap	
	8JD 156 150-807 9.1029.09	Two pole plug with terminals and seals Mounting frame	
Compliance	Ei 917		



P/N 9GH 152 654-007



P/N 8JD 156 150-807

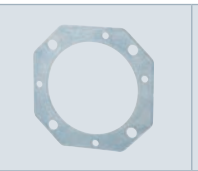

P/N 9.1029.09

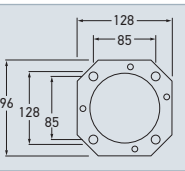

P/N 9.1029.09



P/N 1030-24V

**178mm H4 Halogen
High/Low Beam Insert**

Semi-sealed headlamp with sealing cap.

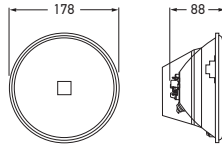

Part Number	1056		
Bulbs to Suit	Headlamp:	12V XD1260/55	24V XD2475/70
Compliance	E4 53		

Where front position lamp is required, use P/N 1058.



Rear view

**178mm H4 Halogen
High/Low Beam Insert**

Semi-sealed headlamp with front position lamp bulb holder (includes P/N HL124 bulb) and sealing boot.



Part Number	1058		
Bulbs to Suit	Headlamp:	12V XD1260/55	24V XD2475/70
	Front position:	HL124	HL244
Compliance	E4 53		



Rear view

**178mm H4 Halogen High/Low
Beam Insert - Hardened Glass**

High performance Halogen headlamp insert fitted with extremely robust hardened glass lens providing maximum resistance when subjected to high operating temperatures and thermal shock. Ideal for 24 volt and high wattage bulb applications. Supplied complete with sealing boot and front position lamp bulb holder assembly.



Part Number	1058HD		
Bulbs to Suit	Headlamp:	12V XD1260/55	24V XD2475/70
	Front position:	HL124	HL244
Compliance	E4 53		



Rear view

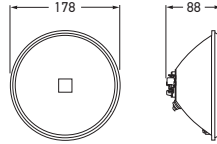

178mm Halogen Driving Lamp Insert

Suitable for use as high beam headlamp in most 178mm round headlamp carriers (eg. P/N 1016).



Part Number	9.1358.01	
Bulbs to Suit	12V 24V	YC1255 YC2470
Compliance	E1 14529	

HEADLAMPS & INSERTS

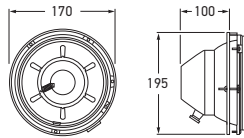

178mm Headlamp Housing

Headlamp housing and chrome rim for halogen or conventional sealed beams and inserts 178mm in diameter. Fully sealed steel cowl, complete with adjusting mechanism for vertical and horizontal alignment, sealing gasket, stainless steel retaining rim and 3 pin wiring harness with separate park lamp connection. Ideal for truck, bus or body builders. Suits Mercedes, Kenworth, Mack, White etc. Outer chrome rim (P/N 1017) to suit headlamp housing P/N 1016.

Part Number	1016	HEADLAMP HOUSING
	1017	CHROME RIM



P/N 1016
Headlamp housing

P/N 1017
Chrome rim

146mm H4 Halogen High/Low Beam Insert

Semi-sealed headlamp with front position lamp bulb holder (includes P/N HL124 bulb) and sealing boot. Suitable for dual headlamp systems.

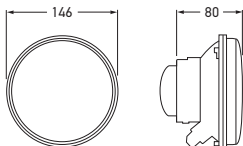

Part Number	1055		
Bulbs to Suit	12V	24V	
	Headlamp:	XD1260/55	XD2475/70
	Front position:	HL124	HL244
Spare Parts	13839700	Front position bulb holder	
	9GH 126 647-011	Sealing boot	
Compliance	E1 17031		



Rear view

Sealing boot

146mm H4 Halogen High/Low Beam Insert - Hardened Glass

High performance Halogen headlamp insert fitted with extremely robust hardened glass lens, providing maximum resistance when subjected to high operating temperatures and thermal shock. Ideal for 24 volt and high wattage bulb applications. Supplied complete with sealing boot and front position lamp bulb holder assembly.



Part Number	1055HD		
Bulbs to Suit	12V	24V	
	Headlamp:	XD1260/55	XD2475/70
	Front position:	HL124	HL244
Compliance	E1 17031		



Rear view

146mm H1 Halogen Low Beam Insert

Low beam insert with front position lamp bulb holder and sealing boot. Suitable for dual headlamp systems.



Part Number	1054		
Bulbs to Suit	12V	24V	
	Headlamp:	C1255	C2470
	Front position:	HL124	HL244
Spare Part	9GH 113 763-001	Sealing boot	
Compliance	E1 7076		



Rear view

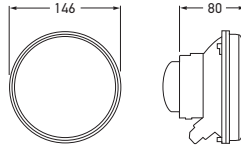

**146mm H1 Halogen
High Beam Insert**

Semi-sealed headlamp, for high beam section of dual headlamp systems with sealing boot.



Part Number	1053		
Bulbs to Suit	Headlamp:	12V C1255	24V C2470
Spare Part	9GH 113 763-001	Sealing boot	
Compliance	Ⓔ 14464		
Earth terminal is a 'Post' (bullet) type connection.			

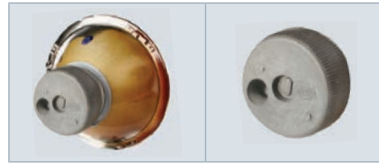

Rear view

Sealing boot

HEADLAMPS & INSERTS

**146mm H1 Halogen
Long Range Driving Insert**

Semi-sealed headlamp, for high beam section of dual headlamp systems and sealing boot.



Part Number	1040		
Bulbs to Suit	Headlamp:	12V C1255	24V C2470
Spare Part	9GH 113 763-001	Sealing boot	



Rear view

Sealing boot

165 x 100mm H4 Halogen High/Low Beam Insert

Semi-sealed headlamp and front position lamp with sealing boot.

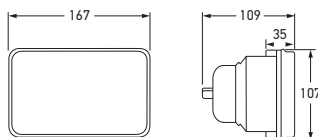

Part Number	1044		
Bulbs to Suit	Headlamp:	12V XD1260/55	24V XD2475/70
	Front position:	HL124	HL244
Spare Part	9FF 126 444-001	Front position bulb holder	
Compliance	E1 7197		



Rear view

165 x 100mm H4 Halogen High/Low Beam Insert

Semi-sealed headlamp with sealing boot and wiring adaptor.



Part Number	1042		
Bulbs to Suit	Headlamp:	12V XD1260/55	24V XD2475/70
Spare Part	9GH 126 647-011	Sealing boot	
Compliance	E1 7197		



Rear view

Sealing boot

165 x 100mm H1 Halogen High Beam Insert

Semi-sealed headlamp with sealing cap.



Part Number	1041		
Bulbs to Suit	Headlamp:	12V C1255	24V C2470
Compliance	E1 24504		



Rear view

200 x 142mm H4 Halogen High/Low Beam Insert

Semi-sealed headlamp with front position lamp bulb holder (includes P/N HL124 bulb).



Part Number	1043		
Bulbs to Suit	12V	24V	
	Headlamp:	XD1260/55	XD2475/70
	Front position:	HL124	HL244
Spare Parts	13839700	Front position bulb holder	
	9GH 126 647-011	Sealing boot	
Compliance	(E) 17009	(E) 17119	



Rear view

Sealing boot

HEADLAMPS & INSERTS

Rectangular Headlamp Housing

Suits 200 x 142mm rectangular headlamp units (P/N 1043). Ideal for truck, bus or body builders.

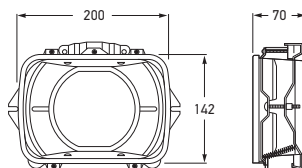

Part Number	1024		
--------------------	-------------	--	--



Twin Rectangular Headlamp Housing

For most 165 x 100mm rectangular headlamp units. Chrome plated outer rim. Complete with adjusting mechanisms for vertical/horizontal alignment and wiring loom. Ideal for truck, bus or body builders.

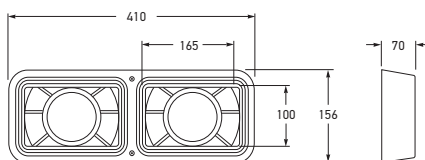

Part Number	1025		
Spare Part	9.1025.07	Chrome plated outer rim	



3-Series (E36) Compact
03/94 - 08/00



HEADLAMP (HB3/HB4) WITH ELECTRIC LEVELLER	
Part Number	1LJ 007 143-051 LH
	1LJ 007 143-061 RH
Bulbs to Suit	Dipped beam: CC1255 Main beam: CB1265 Position: W125
Spare Parts	9ES 145 251-005 Cover lens LH 9ES 145 252-005 Cover lens RH
Compliance	LH (E) 80
	RH (E) 81

HEADLAMPS & INSERTS

3-Series (E36) 09/90 - 09/94



HEADLAMP (H1)	
Part Number	1AL 007 045-011 LH
	1AL 007 045-021 RH
Bulbs to Suit	Headlamp: C1255 x 2 Position: W125
Compliance	(E) 8026

3-Series (E36) 12/90 - 08/00



FOG LAMP (H1)	
Part Number	1NB 006 270-051 LH
	1NB 006 270-061 RH
Bulb to Suit	C1255
Compliance	(E) 18236

3-Series (E46) 02/98 - 09/01



	FOG LAMP (HB4)	
Part Number	1ND 007 646-011	LH
	1ND 007 646-021	RH
Bulb to Suit	CC1255	
Compliance	E13 305	



HEADLAMPS & INSERTS

5-Series (E60) 07/03 - 12/04

BMW 5-Series E60/E61 headlamp featuring Bi-Xenon® and Celis technology.



	HEADLAMP (BI-XENON®)	
Part Number	1LL 160 695-001	LH
	1LL 160 696-001	RH
Bulbs to Suit	Dipped Beam:	D2S
	Main beam:	CA1255
	Indicator:	RY1221
Compliance	E1 1490	E1 1491



5-Series (E60) 07/03 - 03/07

Clear lens style tail lamps. Includes two tail lamp assemblies with instructions.



Part Number	2SK 008 679-811	SET
Compliance	E4 10139	



5-Series (E39) 09/00 - 06/04



HEADLAMP (H7/H7) WITH ELECTRIC LEVELLER	
Part Number	1LL 008 053-591 LH
	1LL 008 053-601 RH
Bulbs to Suit	Headlamp: CA1255 x 2 Indicator: RY1221 Position: YL1210
Spare Part	9DX 153 746-011 Position lamp bulb holder
Compliance	E1182

Headlamp Adaptor Lead Set

To adapt headlamp P/Ns 1LL 008 053-591/-601 to E39 from 12/95 to 09/00. One set required per car.



Part Number	8KB 157 198-801	SET
-------------	-----------------	-----

5-Series (E39) 09/97 - 08/00

Front fog lamps with H7 bulbs and Free-Form (FF) reflector.

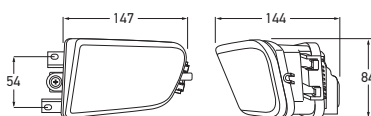

FOG LAMP (H7)	
Part Number	1NA 009 026-011 LH
	1NA 009 026-021 RH
Bulb to Suit	CA1255
Compliance	E12 19094

5-Series (E39) 11/95 - 08/00

Innovative combination rear lamp with a brilliant appearance using the Celis light guide technology for the tail light function. The position light is produced by 8 red LEDs arranged in horizontal light guide strips.



Part Number	2VP 008 272-861	SET
Bulbs to Suit	Stop: R1221 Indicator: RY1221	
Compliance	E1 1070 E1 1071	

5-Series (E34) 09/88 - 03/97
and 7-Series (E32) 09/88 - 05/94



Part Number	DIPPED BEAM LENS	MAIN BEAM (H1)	
	9BG 135 927-011		1K3 132 253-011
9BG 135 928-011		1K3 132 266-011	RH
Bulb to Suit	C1255		
Compliance	Dipped beam:	(E) 7407	
	Main beam:	(E) 34572	



3-Series (E30) 01/83 - 08/87



Part Number	MAIN BEAM (H1)	
	1K3 126 046-001	
1K3 126 680-001		RH
Bulb to Suit	C1255	
Compliance	(E) 14464	



3-Series (E30) 09/88 - 06/94



Part Number	DIPPED BEAM LENS	MAIN BEAM (H1)	
	9BG 135 941-011		1K3 134 855-011
9BG 135 942-011		1K3 134 856-011	RH
Bulb to Suit	C1255		
Compliance	Dipped beam:	(E) 7407	
	Main beam:	(E) 34572	



**Headlamp/Front Direction
Indicator/Front Position Lamp**

Housing made of black impact and chemical resistant material. Suitable for 146mm (5 ¾") H4 headlamp inserts.

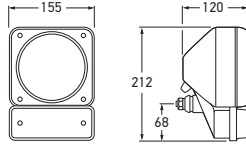

Part Number	1001		
Mounting	Suitable for horizontal and vertical mounting.		
Bulbs to Suit		12V	24V
Dipped/Main beam:	XD1260/55	XD2475/70	
Indicator:	R1221	R2421	
Position:	HL124	HL244	
Spare Parts	1055 9.1001.01	Headlamp insert Lens - Indicator	
Compliance	Headlamp:	E1 17031	
	Indicator:	E12 016086	

HEADLAMPS & INSERTS

**H4 Halogen High/Low Beam
Headlamp Assembly**

Lamp unit, lens dimensions 352 x 195mm, complete with mounting frame and adjusting mechanisms for vertical and horizontal alignment. Fully enclosed housing with removable rear sealing cap for bulb replacement access. Ideal for truck, bus or body builders.

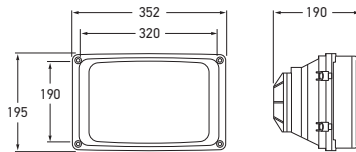

Part Number	1027		
Mounting	Simple four point mounting.		
Bulbs to Suit		12V	24V
Headlamp:	XD1260/55	XD2475/70	
Front position:	HL124	HL244	
Spare Parts	9.1027.01 9.1027.02 9.1027.04	Clear lens Reflector Sealing cap	
Compliance	E1 17016		

**Headlamp VW Golf III
(11/91 - 8/97)**

Headlamp for vehicles with or without headlamp leveller.



Part Number	1LJ 006 360-671		LH
	1LJ 006 360-681		RH
Bulbs to Suit	Headlamp:	CA1255 x 2	
	Position:	W125	
Compliance	LH:	E1 27001 E1 44468	RH: E1 27002 E1 44469

**Headlamp VW Golf III
(11/91 - 8/97)**

Headlamp for use with H4 bulb.



Part Number	1LJ 007 235-251		LH
	1LJ 007 235-261		RH
Bulbs to Suit	Headlamp:	XD1260/55	
	Position:	W125	
Compliance	LH:	E1 17191	RH: E1 17192

HEADLAMPS AND INSERTS

Part Number	4972-H1	H1
	4972-H4	H4
	4972-H7	H7

Bulb Connectors

Plug with pre-installed leads and crimp connectors (H1 and H7). Adapts to original wiring by crimp connector and heat shrink insulator, H4 version with 200mm leads (no connectors).



P/N 4972-H7

P/N 4972-H1

HEADLAMPS & INSERTS

Part Number	5DV 007 760-631	12 VOLT
	5DV 007 810-171	24 VOLT

To Suit Bulb P/Ns D2S and D2R.

See page 146 for HID work lamp power packs.

HID Gas Discharge (G3) Power Pack



HID Gas Discharge (G4) Power Pack

Part Number	5DV 008 855-001	12 VOLT
	5DV 008 856-001	24 VOLT

To Suit Bulb P/Ns D1S and D1R.

See page 146 for HID work lamp power packs.



HID Gas Discharge Ignitor

Part Number	5DD 008 319-501	12 VOLT
-------------	-----------------	---------

To Suit Bulb P/Ns D2S and D2R



SEALED BEAM CHART BY DIMENSION

146MM (5 3/4")				114MM (4 1/2")			
Part Number	Voltage/Wattage	Description	Trade No.	Part Number	Voltage/Wattage	Description	Trade No.
1078	12V-60W	Flood	4478	1085	12V-35W	Flood	4411
1080	24V-80/60W	High/low	4579-2	1087	12V-30W	Spot	4416
1094	12V-100W	Long range	4537-2	1089	12V-100W	Spot - long range	4509
1096	24V-60W	Flood	4578	1092	24V-50W	Spot	4505
				1098	12V-40/40W	High/low	4440X

146mm Flood Lamp Beam

Flood lamp beam to suit construction and industrial machinery.

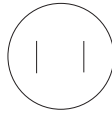

2 contact lugs

Part Number	1078
Trade Part No.	4478
Voltage	12V
Power Consumption	60W

146mm High/Low Beam

High/low beam to suit construction and industrial machinery.

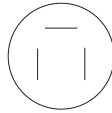

3 contact lugs

Part Number	1080
Trade Part No.	4579-2
Voltage	24V
Power Consumption	Dipped beam: 60W Main beam: 80W
Not for road use as light pattern is for right-hand side traffic.	

146mm Long Range Beam

Search lamp/work lamp beam.

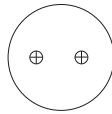

2 screw terminals

Part Number	1094
Trade Part No.	4537-2
Voltage	12V
Power Consumption	100W

146mm Flood Lamp Beam

Flood lamp beam to suit construction and industrial machinery.

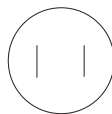

2 contact lugs

Part Number	1096
Trade Part No.	4578
Voltage	24V
Power Consumption	60W

114mm Flood Lamp Beam

Flood lamp beam to suit tractor applications.

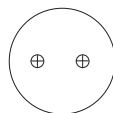

2 screw terminals



Part Number	1085
Trade Part No.	4411
Voltage	12V
Power Consumption	35W

114mm Spot Lamp Beam

Spot lamp beam to suit hand held spot lamp P/N 1521 and automotive applications.

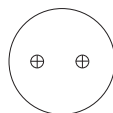

2 screw terminals



Part Number	1087
Trade Part No.	4416
Voltage	12V
Power Consumption	30W

114mm Spot Lamp/Long Range Beam

Spot lamp beam to suit hand held spot lamp P/N 1520.

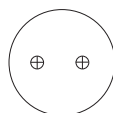

2 screw terminals



Part Number	1089
Trade Part No.	4509
Voltage	12V
Power Consumption	100W

114mm Spot Lamp Beam

Spot lamp beam to suit hand held spot lamp P/N 1525.

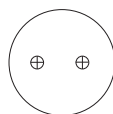

2 screw terminals



Part Number	1092
Trade Part No.	4505
Voltage	24V
Power Consumption	50W

114mm Spot High/Low Beam

High/low beam to suit tractor and automotive applications.

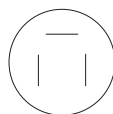

3 contact lugs



Part Number	1098
Trade Part No.	4440x
Voltage	12V
Power Consumption	Dipped/Low Beam: 40W